







EAST

NOTES:

170 SQM / 1900SQ FT
 FCL 3.3M
 U/B HEIGHT 3M

1 X 63AMP
 10 X 13AMP

KEY:

-  DOUBLE 13AMP SOCKET
-  32 AMP SOCKET
-  63 AMP SOCKET
-  16 AMP SOCKET
-  13AMP FLOOR BOX
-  ETHERNET

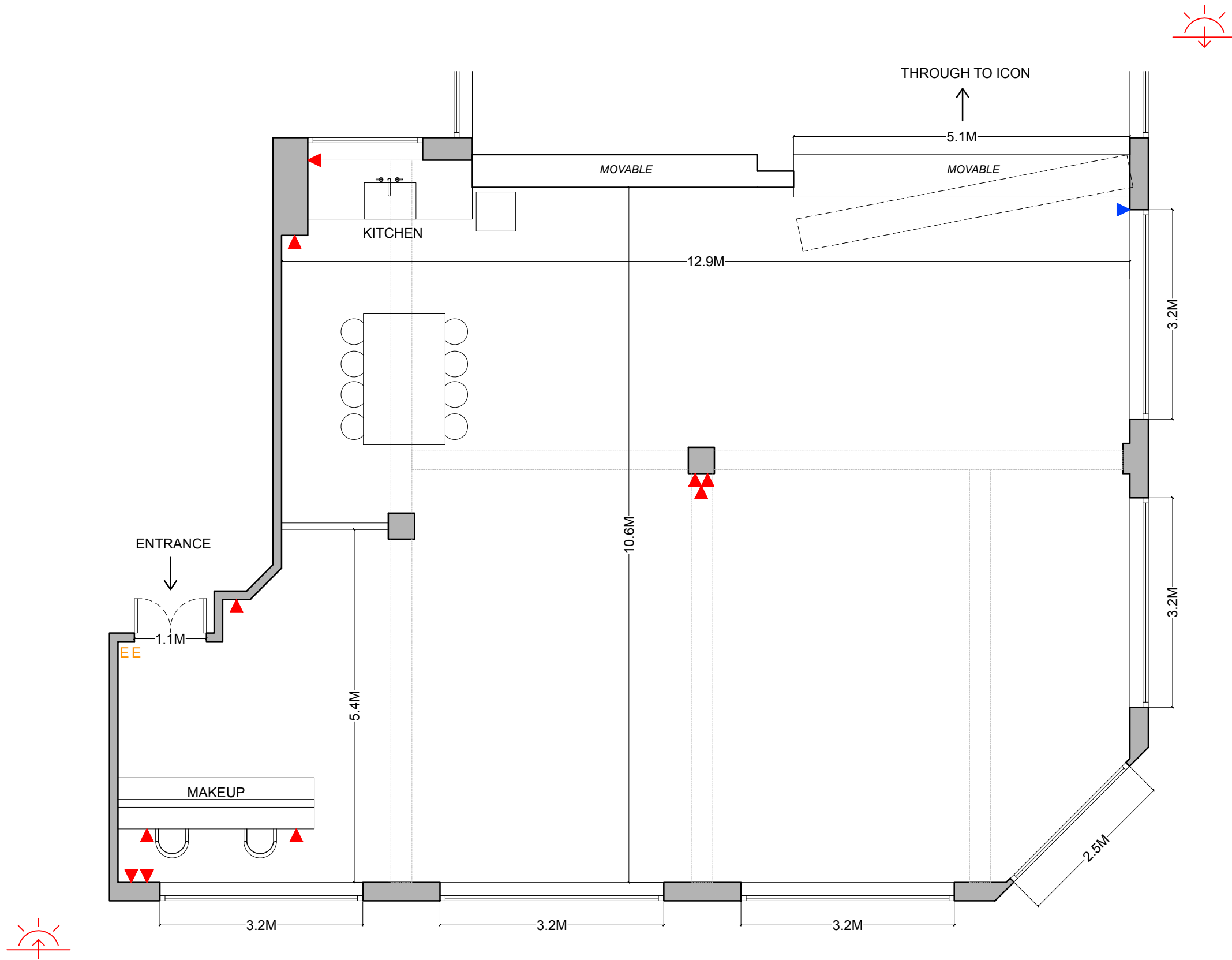

REV.	ISSUE	DATE
/	DESIGN INTENT	10/09/2018

Notes:
 Do not scale from drawings.
 Errors to be reported immediately to the Architect.
 To be read in conjunction with all relevant Architects',
 Services and Structural Engineers' drawings.
 All existing site, tree and building information has been compiled from
 different sources. All dimensions to be checked on site.



Project: WIMBORNE HOUSE 151-155 New North Road N1 6TA	Project No. 1000 Drawing No. 1000-JJ EAST
Client: JJ MEDIA GROUP	Drawn: JF
Date: 10/09/2018	Checked:
Scale / Format: 1:75 @ A3	
Drawing Name: EAST GA PLAN	Issue: /